

# PIAZZA II LED

# THORN

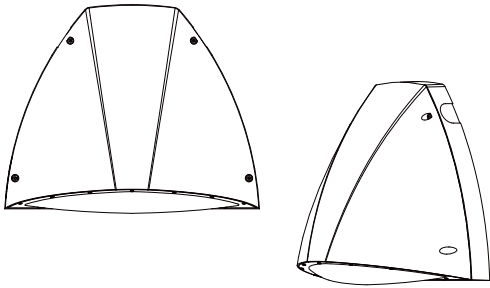

- |           |                        |           |                           |
|-----------|------------------------|-----------|---------------------------|
| <b>CZ</b> | Montážní návod         | <b>IT</b> | Istuzioni di montaggio    |
| <b>DE</b> | Montageanleitung       | <b>LT</b> | Montavimo Instrukcijos    |
| <b>DK</b> | Monteringsvejledning   | <b>LV</b> | Instalācijas instrukcija  |
| <b>EE</b> | Paigaldusjuhend        | <b>NO</b> | Monteringsanvisning       |
| <b>FI</b> | Asennusohje            | <b>PL</b> | Instrukcja montażu        |
| <b>FR</b> | Notice de montage      | <b>RU</b> | Инструкция по монтажу     |
| <b>HU</b> | Szerelési útmutató     | <b>SE</b> | Installationsanvisning    |
| <b>IT</b> | Istuzioni di montaggio | <b>UK</b> | Installation Instructions |
| <b>CN</b> | 安装说明书                  |           |                           |

CE IK10 IP65

**1.**

	b1	b2
HF	Φ12.5mm	
HF P	Φ12.5mm	
HFI-X	Φ12.5mm	Φ12.5mm
HF E3	Φ16.5mm	
HF E3TX	Φ16.5mm	Φ12.5mm

Type of cable	Φ
HF	3x1.0 mm <sup>2</sup> Φ12mm
HF P	3x1.0 mm <sup>2</sup> Φ12mm
HFI-X	3x1.0 mm <sup>2</sup> Φ12mm
HF E3	2x1.0 mm <sup>2</sup> Φ12mm
HF E3	4x1.0 mm <sup>2</sup> Φ16mm
HF E3TX	4x1.0 mm <sup>2</sup> Φ16mm
HF E3TX	2x1.0 mm <sup>2</sup> Φ12mm

Rubber ring C Φ10\*4.5  
Washer B Φ10\*4.5  
Screw A ST4.2\*25

Part A/B/C is not an included accessory.

Model	Terminal 1	Terminal 2	Terminal 3	Terminal 4
HF/HF P	N	1	2	
HF E3	N	1	2	
HFI-X	N	1	2	DS1 DS2
HF E3TX	N	1	2	DS1 DS2

**2.**

	b1	b2
HF	Φ12.5mm	
HF P	Φ12.5mm	
HFI-X	Φ12.5mm	Φ12.5mm
HF E3	Φ16.5mm	
HF E3TX	Φ16.5mm	Φ12.5mm

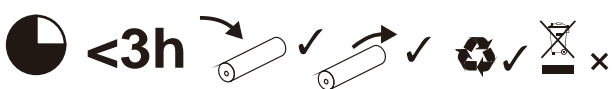
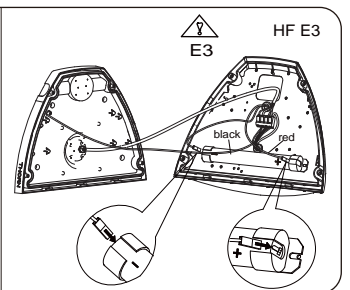
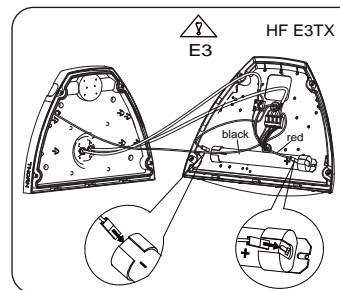
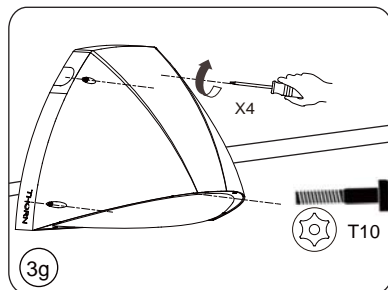
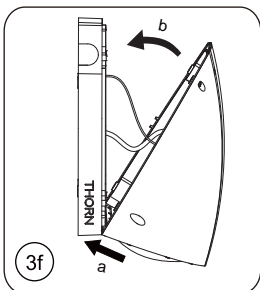
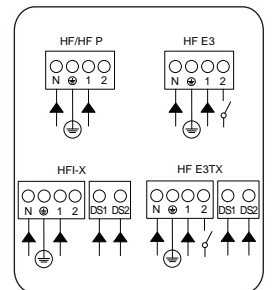
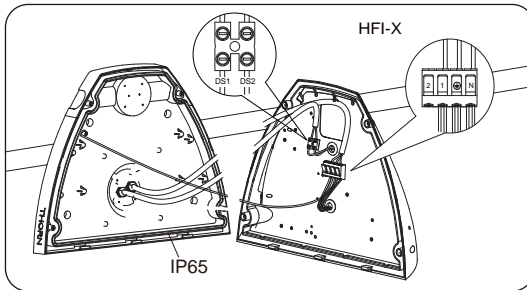
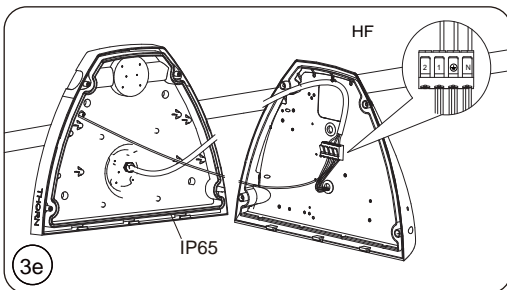
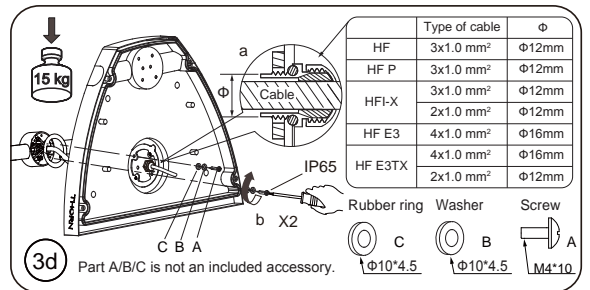
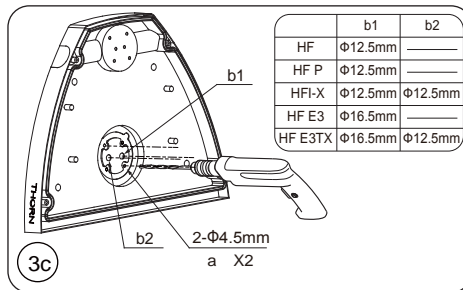
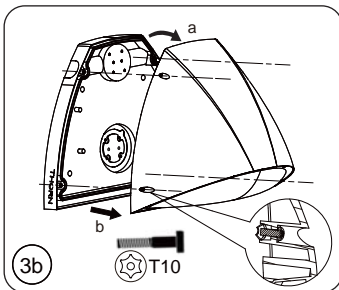
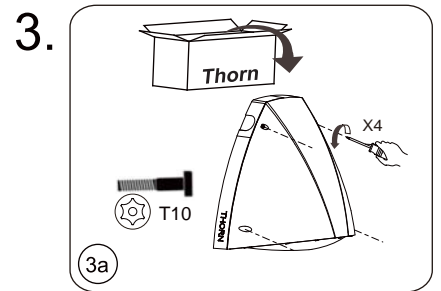
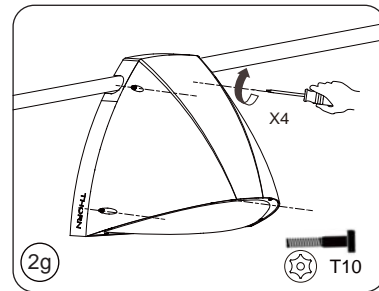
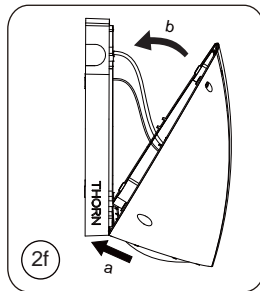
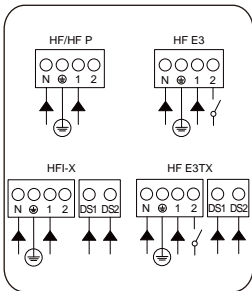
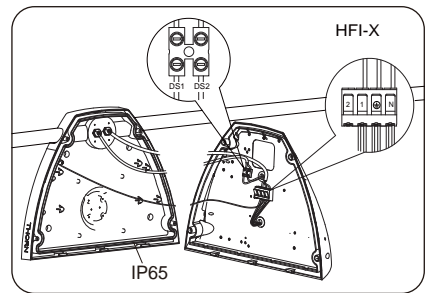
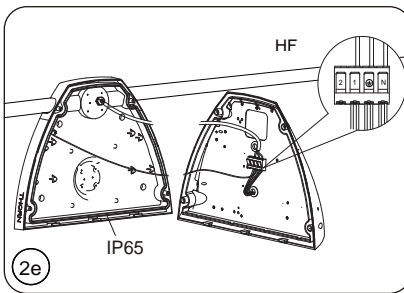
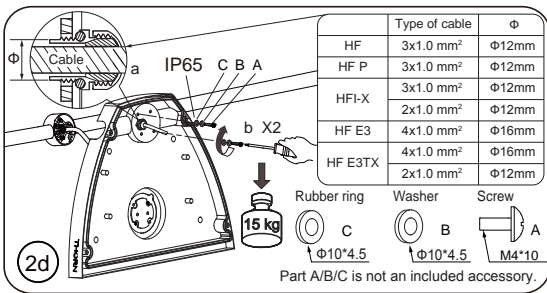

59002205 - BATTERY STK 4 X NiCd D 55° TH