

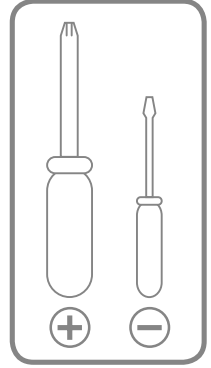

DC315XXP2/BS

Contents **DE** Inhalt **FR** Contenu **UK** Inhoud **FI** Sisältö
 UK Inhold **IT** Contenuto **ES** Contenido **PT** Conteúdo
GR Περιεχόμενα **SE** Innehåll

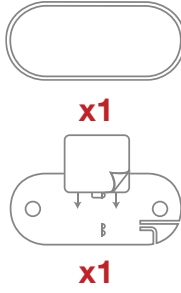

Getting started **DE** Erste Schritte **FR** Démarrage **UK** Aan de slag **FI** Aloitusopas **DK** Kom i gang
IT Operazioni preliminari **ES** Para empezar **PT** Para começar **GR** Πρώτα βήματα **SE** Kom igång

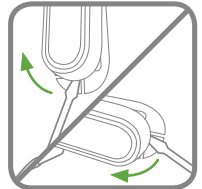
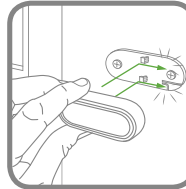
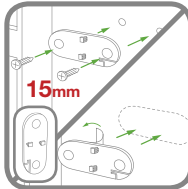
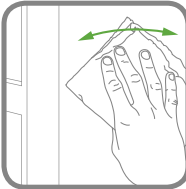
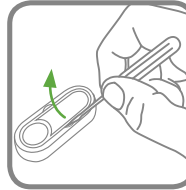
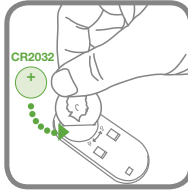
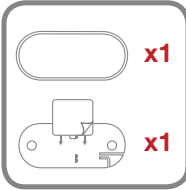
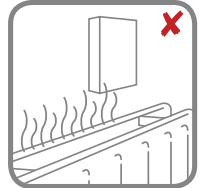
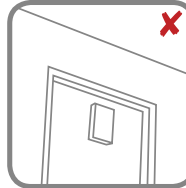

03 Optional features 04 Optionale Funktionen 05 Options disponibles 06 Opties
 07 Valinnaiset ominaisuudet 08 Valgfrie funksjoner 09 Funkcionalită opționale
 10 Opciones disponibles 11 Funções opcionais 12 Προαιρετικές λειτουργίες πρόσθετων
 13 Mõiljuga funktsioner

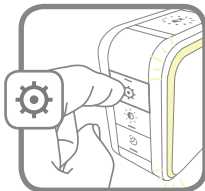
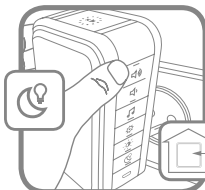
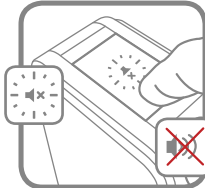
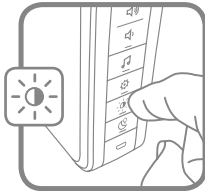

	Hello	Ding Dong	Westminster	Marimba	Piano	Bell	Telephone	Soft Alert
	•	•					•	•
	•	•	•	•				•
	•	•	•	•	•	•	•	•

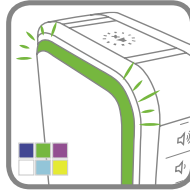
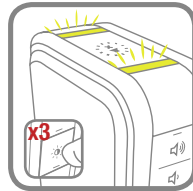

		3Hrs		6Hrs
		9Hrs		12Hrs

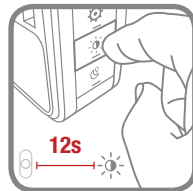
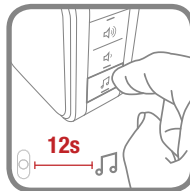
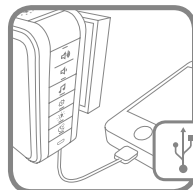

06 Linking 07 Enllemen
 08 Programmation 09 Verknüpfung
 10 Linkitiamen 11 Forbinde
 12 Coligamento 13 Enlace 14 Pro-
 gramção 15 Ouhõõõõõõ 16 Länkning



08 Trouble shooting 09 Fehlerbehebung 10 Dépannage 11 Probleemoplossing
 12 Vianmääritys 13 Problemlösning 14 Risoluzione dei problemi 15 Solución de
 problemas 16 Resolución de problemas 17 Αντιμετώπιση προβλημάτων 18 Felsõkning

livewell.honeywell.com



32305355-001 Rev.A