

DE Contents **DE** Inhalt **FR** Contenu **NL** Inhoud  
**F** Sisältö **DK** Indhold **IT** Contenuto  
**ES** Contenido **PT** Conteúdo **GR** Περιεχόμενα  
**SE** Innehåll

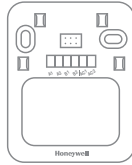

x1



x1



x2



x2

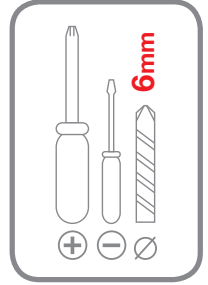

6mm

**DE** Getting started **DE** Erste Schritte **FR** Démarrage **NL** Aan de slag  
**F** Aloitusopas **DK** Kom i gang **IT** Operazioni preliminari **ES** Para empezar  
**PT** Para começar **GR** Πρώτα βήματα **SE** Kom igång

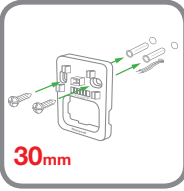
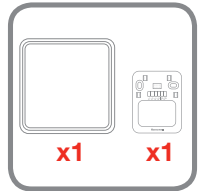
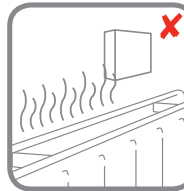
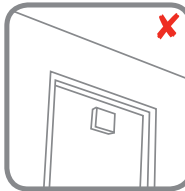
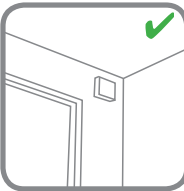

30mm

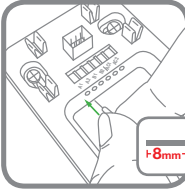

8mm

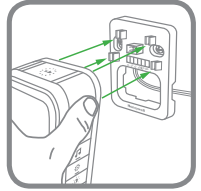
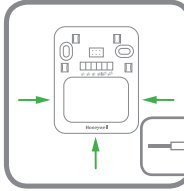

6B Wired push with batteries 6B Verdrahteter Druckkaster mit Batterien 6B Bouton pousseur câblé avec transformateur 6B Bekabelde drukknop met batterijen  
 6F Jõhõdetetu painike paristõõlita 6F Kabelit tryk med batterier 6F Pulsante cablato con batterie 6F Pulsator cableado con baterías 6F Boião com fios com pilhas  
 6F Καλωδιωμένο ωστήριο με μπαταρίες 6F Trådbrunden tryckknapp med batterier

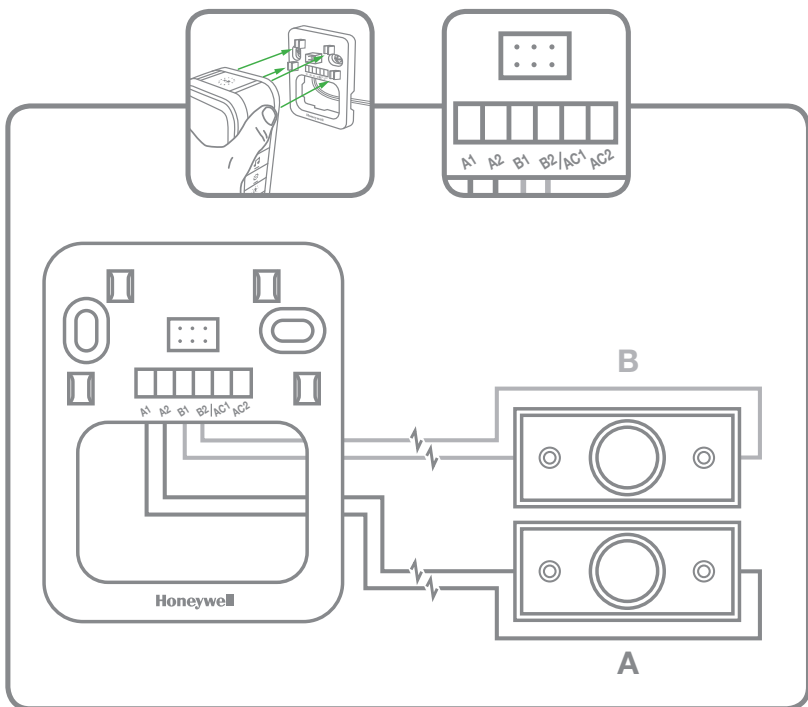
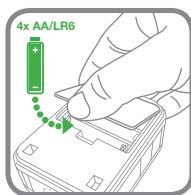
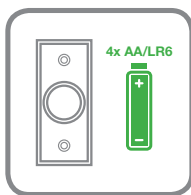

03 Wired illuminated push with transformer 03 Verdrahteter Druckknopf mit Beleuchtung und Transformator 03 Bouton poussoir éclairé avec transformateur  
 04 Verlichte bekabelde drukknop met transformator 04 Johdotettu valaistu painike muuntajalla 04 Kabiel belyst tryk med transformør  
 05 Pulsante cablato illuminato con trasformatore 05 Pulsador iluminado cableado con transformador 05 Botão iluminado com fios com transformador  
 06 Καλωδιωμένο φωτιστικό με μετασχηματιστή 06 Trådbunden opplyst tryckknapp med transformator

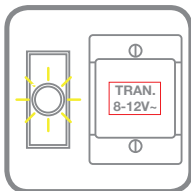

03 Always ensure the main supply is disconnected before installation, follow Transformer Instructions.

04 Immer daran denken, die Hauptversorgung vor der Installation abzuschalten, Dazu die Transformatoranweisungen befolgen.

05 Assurez-vous toujours que l'alimentation principale est déconnectée avant l'installation. Respectez les consignes concernant le transformateur.

06 Zorg er altijd voor dat de hoofdtoevoer afgesloten is voordat er met de installatie begonnen wordt, volg de instructies voor de transformator.

07 Varmista aina, että päävirransyöttö on katkaistuna ennen asennusta, ja noudata muuntajan ohjeita.

08 Sørg alltid for, at strømmen er afbrudt før installation. Følg Transformer instruktionerne.

09 Assicurarsi sempre che l'alimentazione principale sia scollegata prima di procedere con l'installazione. Seguire le istruzioni relative al trasformatore.

10 Asegúrese siempre de que el suministro eléctrico está desconectado antes de la instalación, siga las instrucciones del transformador.

11 Certifique-se sempre de que a fonte de alimentação principal é desligada antes da instalação e siga as instruções do transformador.

12 Να βεβαιώνετε πάντοτε ότι η κύρια παροχή είναι αποσυνδεδεμένη πριν από την εγκατάσταση, τηρείτε τις Οδηγίες για τον Μετασχηματιστή

13 Se alltid till att elnätet är bortkopplat innan installationen och följ transformatorns instruktioner.

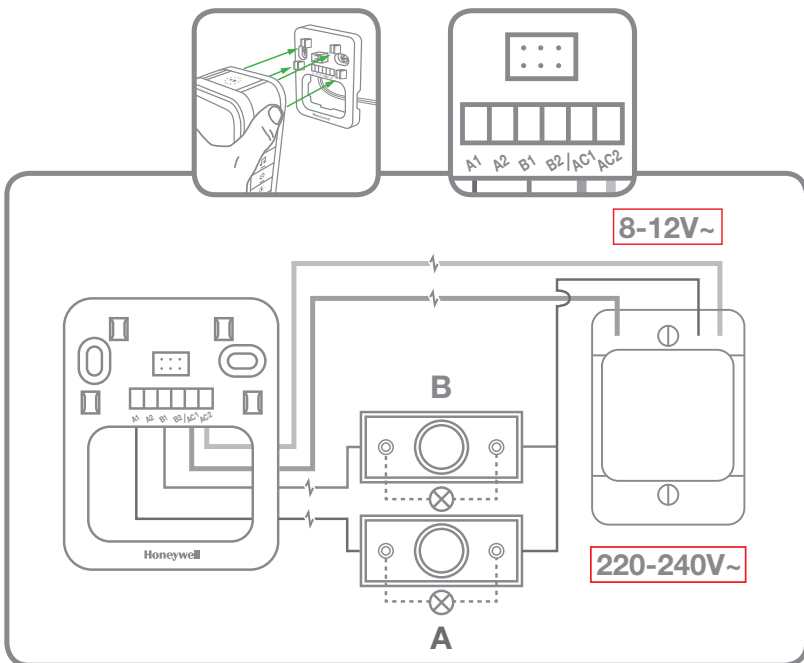

GB Optional features 05 Optionale Funktionen 07 Options disponibles 08 Opções disponíveis 09 Valinnaiset ominaisuudet 10 Valgriite funktioner 11 Funzionalità opzionali 12 Opciones disponibles  
 FI Funções opcionais 06 Προαιρετικές λειτουργίες 04 Возможные функции



|  | Hello | Ding Dong | Westminster | Marimba | Piano | Bell | Telephone | Soft Alert |
|--|-------|-----------|-------------|---------|-------|------|-----------|------------|
|  | •     | •         |             |         |       |      | •         | •          |
|  | •     | •         | •           | •       |       |      | •         | •          |
|  | •     | •         | •           | •       | •     | •    | •         | •          |

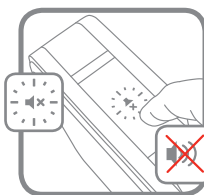
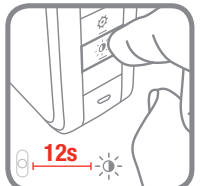
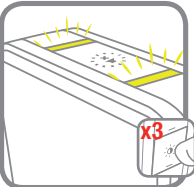
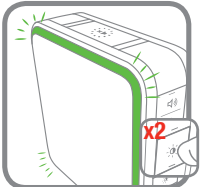
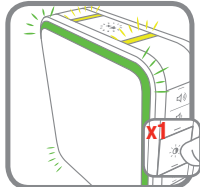

|  |  |  |  |  |  |
|--|--|--|--|--|--|
|  |  |  |  |  |  |
|  |  |  |  |  |  |



GB Trouble shooting 09 Fehlerbehebung 08 Dépannage 06 Probleemoplossing  
 FI Vianmääritys 04 Problemlösning 11 Risoluzione dei problemi 12 Solución de problemas  
 PT Resolução de problemas 06 Αντιμετώπιση προβλημάτων 04 Felsöknung

[livewell.honeywell.com](http://livewell.honeywell.com)



32304380-001 Rev.A